

State of S^c Carolina

(400)

Pursuant to a warrant from
 John Thomas - Com^r of Co^{ty} of Co^{ty} dated 20th
 April 1796, I have admeasured &
 laid out unto Edward More a
 tract of Two hundred six acres
 of land in Washington District
 on branches of Childers, & beaver dam
 creek of south Tigar river in green
 = ville county, bounding by lines
 running N.W. by Thomas Redsworth
 land S.W. & S.E. by land unknown
 = known N.E. by Job Hails land
 and hath such form and Marks
 as the above Plat Represents.

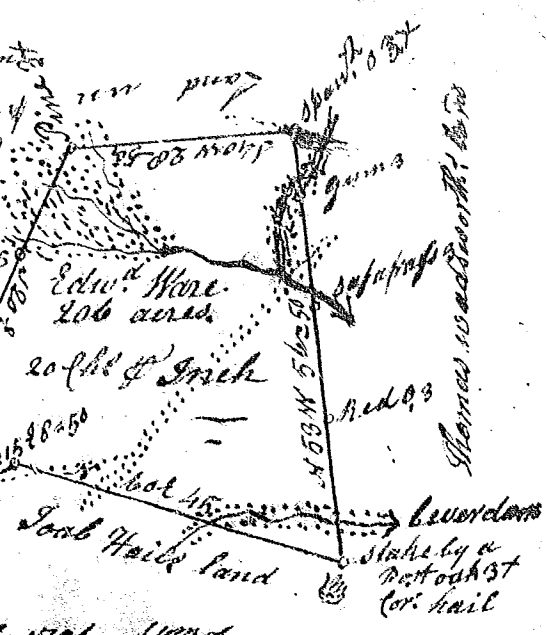

Recorded 7th April 1797 Survey, 26th July 1796, W^m J. Thomas, Sr.

South Carolina Pursuant to a warrant from John Thomas Esq^r
 Pinkney District Com^r of Co^{ty} N^o Saluda dated 5th Oct^r 1799 -
 I have admeasured and laid out unto Barnet Demsey
 a tract of three hundred & ninety six acres of land in
 Spartanburg County



Recorded 17th April 1797 Survey, 1st Dec^r 1795, Jas. Wofford D^r.

South Carolina Pursuant to a warrant
 from John Thomas Com^r of Co^{ty} N^o Saluda dated 5th Oct^r 1795, I have admeasured and
 laid out unto Barnet Demsey a tract of
 three hundred & ninety two acres of land
 in Pinkney District, on a branch of Abner
 Creek of Inoree river running N.W. with
 Hugh Flanigan, S.E. with Williamsons
 N.E. with old line and Barnet Demsey's
 and hath such shape and Marks as the
 above plat Represents Survey, 1st Dec^r 1795.

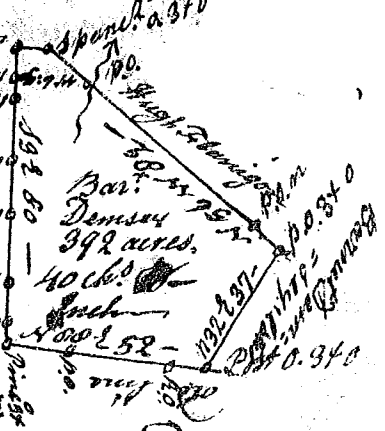

Recorded 17th April 1797 Survey, 1st Dec^r 1795, Jas. Wofford D^r.